

DANUSER

Model G20/40 DIGGER

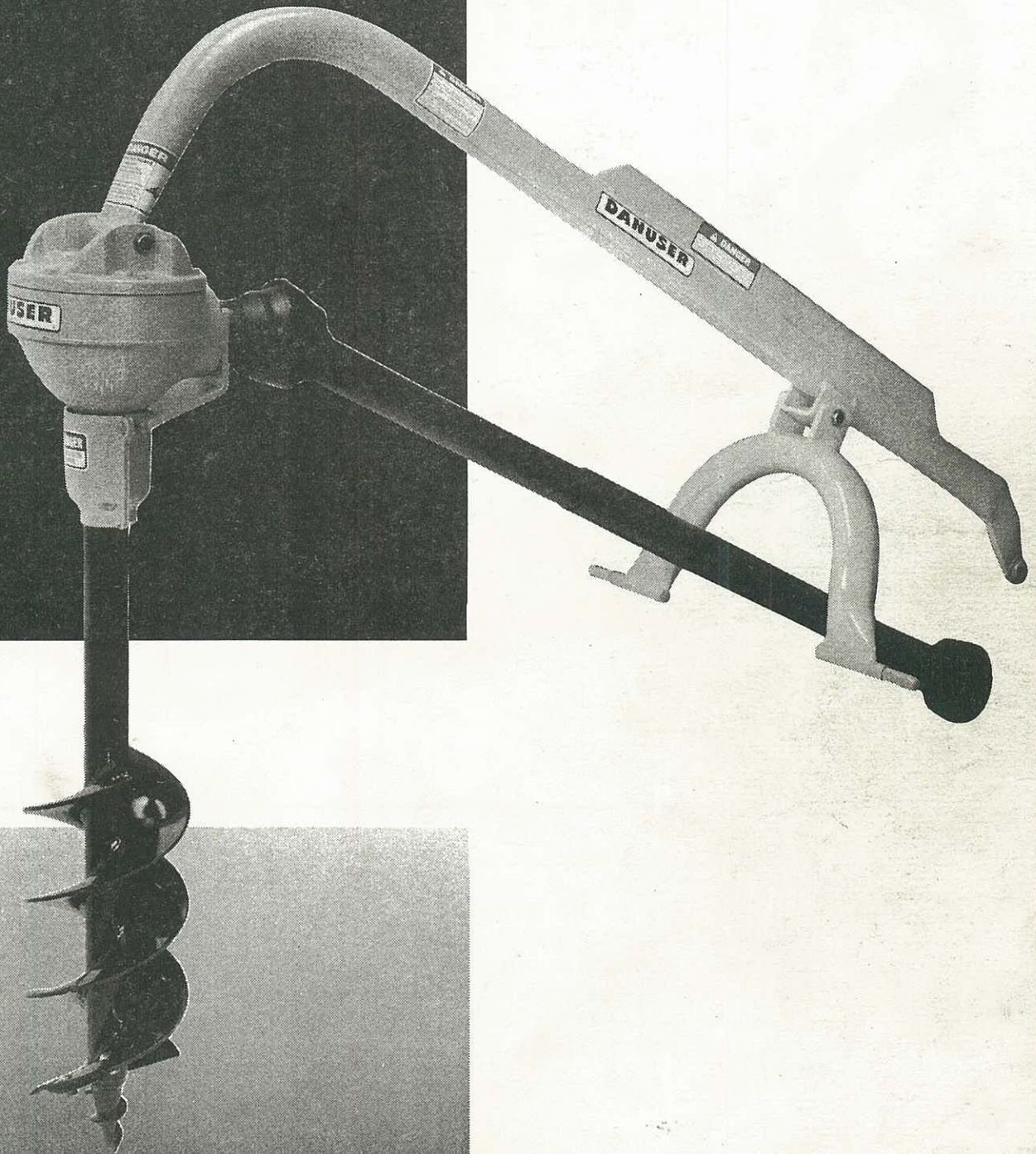

Owner's Manual

Danuser Machine Company, Inc., 500 East Third Street

Fulton, Missouri 65251-0368

Phone 573-642-2246 • Fax 573-642-2240

E-mail danusersales@ktis.net

Web site WWW.DANUSER.COM

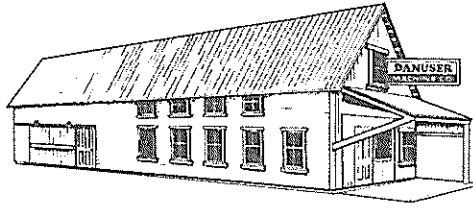

My grandfather, K. B. Danuser, began building wagons and repairing all types of machinery in a small shop in Fulton, Missouri in 1910. With pride in his Swiss craftsmanship, he established one policy for his concern which is the hallmark of Danuser Machine Company to this day—"the job has to be right."

Since 1910

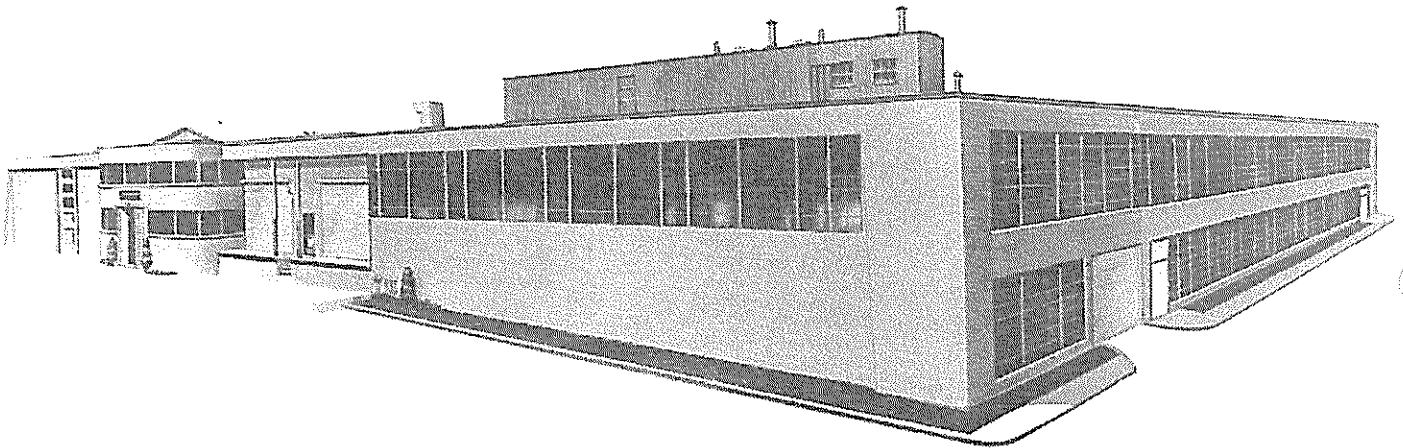

Today, a new, modern plant built by my father, Henry Danuser, is located on the original site. This building and those who work in it are dedicated to the tradition of fine craftsmanship and to the production of better machines for American fields. The challenge of changing economic conditions is being met with improved manufacturing methods to hold the price standards which are an integral part of Danuser Machine Company. From this sound growth will come new products, designed to better serve agriculture and industry.

Jerry Danuser

G20/40 DIGGER

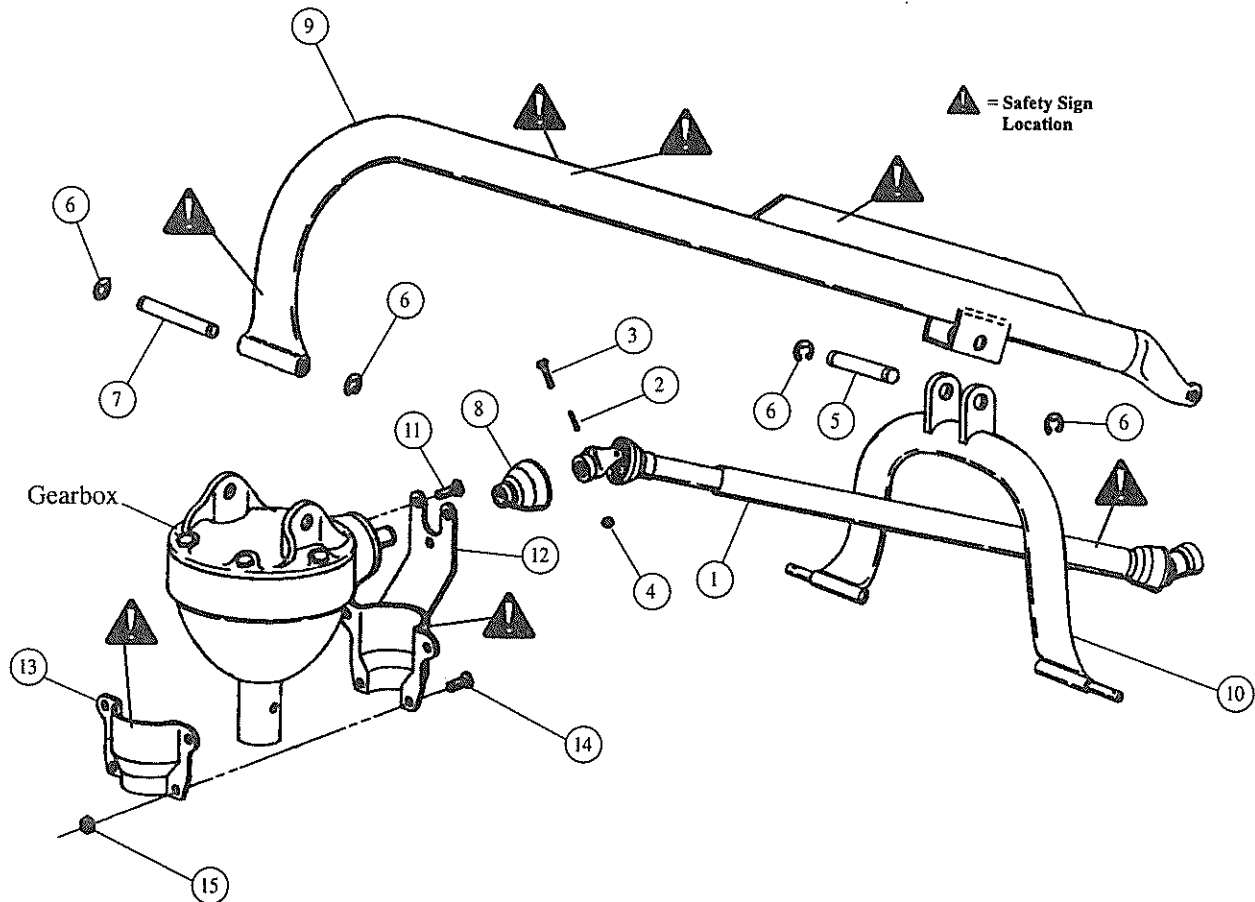

DANUSER G20/40 DIGGER

Ref. No.	Description	Part No.	No. Req'd	Ref. No.	Description	Part No.	No. 'Req'd
Driveline & Hardware Pkg6079.....1 (consists of the following)				10 Yoke Assembly6051.....1			
1	Driveline	6062	1	Gearbox Assembly.....6042.....1 (includes the following)			
2	Roll Pin (3/16 x 1-1/2).....	6061	1	11	Capscrew (7/16-14 x 1-3/4, Gr. 5).....	6059	3
3	Bolt, Shear (5/16-18 x 2-1/4, Gr. 5).....	6015*	3	12	Shield Assembly Bracket.....	6139	1
4	Nut (5/16-18).....	573*	3	13	Shield, Auger Adapter	6137	1
5	Pin (3/4 x 4-15/16).....	6055	1	14	Bolt (3/8-16 x 7/8, Gr. 5).....	2339	4
6	Retaining Ring.....	2172	4	15	Nut (3/8-16).....	2168	4
7	Pin (3/4 x 8).....	6056	1				
8	Guard, Input Shaft	6057	1				
Owner's Manual (in Driveline box)							
9	Boom Assembly	6045	1				

* One required in unit. Two extra included in package for replacement. (SPECIAL BOLT: Use genuine Danuser replacement only.)

Parts

- Decals and Safety Signs
- Digger Parts
- Gearbox Assembly
- Driveline Parts
- Auger Assemblies
- Accessories

Decals and Safety Signs

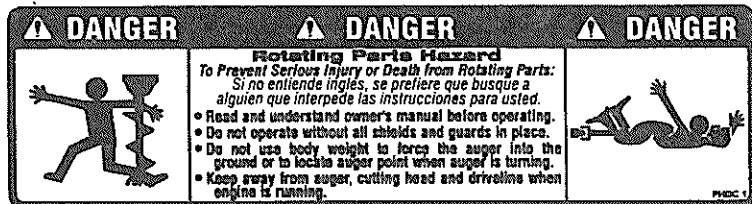

PART NO. PHDC 1
Location: Boom, rear, above Gearbox



PART NO. 2088
Locations: Boom, right side; Gearbox

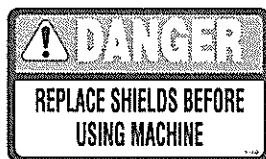

PART NO. 2169
Locations:
Auger Adapter Shield, rear half;
Auger Adapter Shield, front half



WARNING

Clean or replace all safety signs if they cannot be read or understood.

PART NO. PHDC 2
Location: Boom, left side

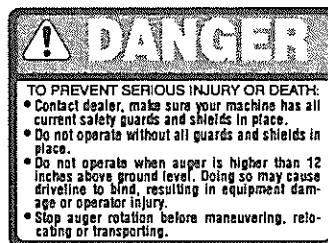
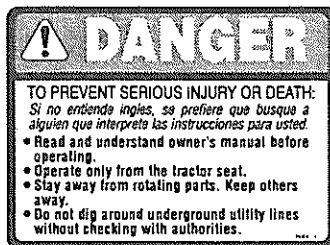

PART NO. PHDC 3
Location: Boom, right side

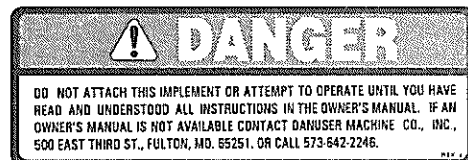

PART NO. PHDC 4
Location: Boom Rib, right side

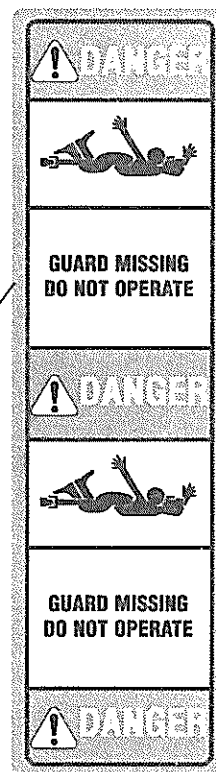

PART NO. 13-10022
Location:
Universal Joint Assembly,
under guard



PART NO. PHDC 5
Location: Auger,
Auger Extension

WARNING

Replace a broken or damaged shear bolt OR auger retaining bolt **ONLY** with an authorized factory replacement. A shear bolt OR auger retaining bolt that is too long increases the possibility of personal injury. The shear bolt and auger retaining bolt must be of the proper size and grade to function properly.

STEP 9: If you break a shear bolt, the roll pin should retain the driveline on the G20/40 digger pinion shaft. Replace the shear bolt as follows:

Shear bolt replacement:

- (a) Remove the broken shear bolt.
- (b) Install a new shear bolt, Danuser PN 6015, and nut, Danuser PN 573. This is a special bolt—use genuine Danuser replacement parts only. *Never* use a bolt longer than 2¼".
- (c) Tighten the shear bolt nut securely.

STEP 10: If the auger becomes lodged on an obstruction below ground, do not attempt to raise the auger by hydraulic lift power alone. Stop the PTO, set brakes, shut off the tractor engine, remove the tractor key and dig around the auger enough to free it from the obstruction before trying to remove the auger from the hole.

WARNING

Before digging around the auger, stop the PTO, set tractor brakes, shut off the tractor engine, and remove the tractor key.

DANGER

Keep others at least twenty-five feet (25') from the auger when applying lift power to raise the freed auger from the ground. Stop auger rotation prior to lifting out of hole.

Apply lift power and slowly rotate the PTO to raise the auger to top of hole.

CAUTION

To avoid damage to universal joints, and to reduce the risk of personal injury, never transport the digger with the tractor PTO engaged.

Maintenance

WHAT TO DO	WHEN
Check digger for loose bolts or fasteners.	Daily
Check auger for loose, worn, or broken cutting edges or point.	Daily
Check gearbox oil level, fill as necessary with multigear lubricant EP SAE 140.	Periodically
Drain gearbox housing, flush, and refill with two quarts of multigear lubricant EP SAE 140.	After 500 hours use
Coat auger with grease to prevent rusting.	After paint has been removed through usage
Lubricate universal drive joints with good quality gun grease.	After 300 holes
Coat the inside of the auger adapter liberally with grease.	Each time an auger or extension is attached to the gearbox

Operation

- Operation
- Transport

CAUTION

The G20/40 digger was designed for 40 HP maximum, Category 1, 3-point hitch, 540-RPM PTO, using sway stabilizers. Auger size must not exceed 24" diameter. Operation of this digger in a manner for which it was not intended will result in poor performance, and could create a hazard and the potential for personal injury.

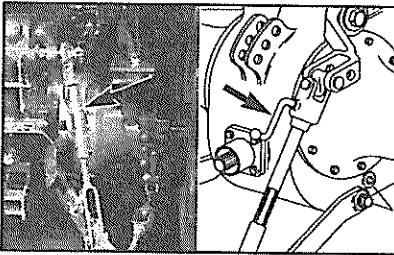

FIG. 10 - LEVELING "CRANK" ON LIFTING LINK

DIFFICULT DIGGING SUGGESTIONS

Worn edges or a slightly rounded point can seriously affect auger penetration. Check for wear before each use, replace as necessary.

Additional options:

Down Force package shown on page 22.

Different auger points shown on page 21.

Different cutting edges shown on page 21.

Hole-Digger Head Augers shown on page 20.

Weld-on Hole-Digger Head shown on page 20.

Study this owner's manual carefully before attempting to operate or adjust the Danuser G20/40 digger. You are responsible for furnishing this manual to others who may use the unit.

WARNING

Personal protection equipment including hard hat, safety glasses, safety shoes, and gloves are recommended during installation, operation, adjustment, maintaining, repairing, removal, or moving the digger. Do not allow long hair, loose fitting clothing, or jewelry to be around moving parts.

DANGER

This Post Hole Digger was designed for one-man operation from the tractor seat. It is the responsibility of the operator to see that no one is in the proximity of the implement when it is started. Do not operate the implement with another person near, or in contact with, any part of the implement, PTO drive line, or auger. Keep bystanders and all other people at least twenty-five feet (25') from all implements in operation or under power. Serious personal injury or death may result if any attempt is made to assist digger operation by hand.

STEP 1: Adjust the auger to a vertical position:

- (a) Raise the auger point off the ground. Turn the adjusting screw (or crank) on the lifting link (see Fig. 10) until the auger appears vertical, looking from the tractor seat.
- (b) Lower the auger slowly until the point just engages the ground. Move the tractor slowly forward or back as needed until the auger is vertical to the ground.

STEP 2: Set the tractor brakes, take tractor out of gear, to hold the tractor on location and to prevent damage to the digger.

STEP 3: With the auger point lowered to the ground, set the engine speed to idle, then engage the PTO. Make sure the auger point is on the ground before engaging the PTO.

STEP 4: Lower the auger into the ground slowly, then increase the speed as required so the dirt is conveyed from the hole. NEVER exceed 540 RPM. In many types of soils, it may be necessary to hold back against the auger screw suction by moving the hydraulic control lever momentarily to either the "hold" or "raise" position to keep the auger from screwing into the ground.

STEP 5: When the auger has been lowered about a foot or so into the ground, raise the auger almost out of the hole, then drill deeper and raise the auger again. Repeat this procedure until the desired hole depth is reached.

STEP 6: When the auger has reached the full depth required, allow the auger to dwell momentarily at this depth at a slower speed to assist in cleaning out the hole.

NOTE

For "heavy" soil conditions or for tractors requiring PTO shaft rotation to produce lifting power, allow the auger to turn at slow speed while raising it to top of the hole.

STEP 7: Disengage the PTO and raise the auger from the hole.

STEP 8: To remove loose dirt from auger, spin the auger by momentarily engaging the PTO with the engine running at a faster speed than used for drilling.

DANGER

To prevent injury, keep an area of at least twenty-five feet (25') around the auger clear of bystanders and all other people.

Troubleshooting

1. Front end of boom contacts tractor when boom is raised or lowered.	(a) Attach the boom to the tractor through a different hole in the upper link bracket. Upper holes will shorten travel, lower holes will increase travel.
	(b) Follow "Adjustment," page 10 & 11, to limit boom travel.
	(c) Relocate or adjust the part of the tractor causing the interference.
2. Digger yoke strikes boom when digger is raised.	(a) Attach the front end of the boom to a more forward hole on the upper link bracket.
	(b) Attach the lower links to rear forward pivot points.
	(c) Lengthen the lower links.
	(d) Follow "Adjustment," page 10 & 11, to limit boom travel.
3. Tractor has difficulty raising auger.	(a) Attach the lift links to more forward holes in the rockshaft lift arms to decrease lift range.
	(b) Move the lift links to more forward holes in the lower links to decrease travel.
	(c) Check the tractor hydraulic system to be sure it is raising and lowering to the maximum and minimum heights recommended in your tractor manual.
4. Driveline strikes tractor power take-off shield when digger is raised.	(a) Follow "Adjustment," page 10 & 11, to limit boom travel.
5. Tractor action is "jerky" with the digger attached, or the hitch raises and lowers rapidly during transport.	(a) Adjust tractor hydraulic system for "position control" implement rather than "draft" or "load control."
	(b) If applicable, lock tractor upper link bracket in a fixed position.

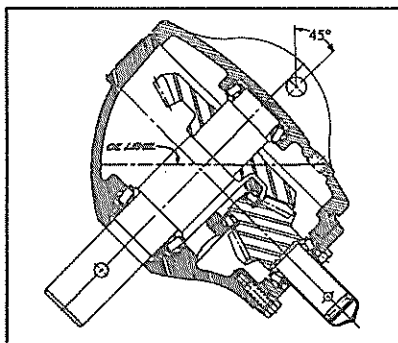

FIG. 5 - PIVOT GEARBOX 45° TO CHECK OIL LEVEL

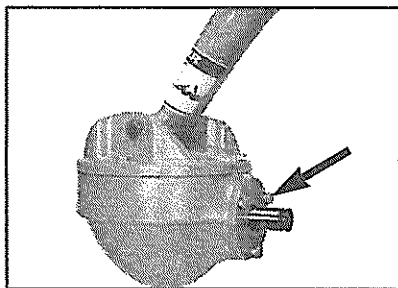

FIG. 6 - REMOVE 3 BOLTS

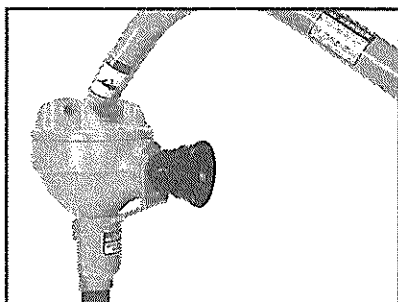

FIG. 7 - INPUT SHAFT GUARD

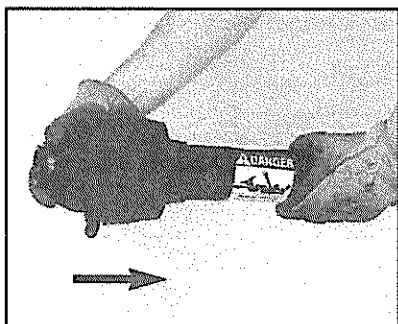

FIG. 8 - RETRACT RING FOR INSTALLATION

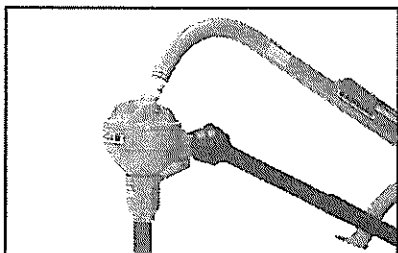

FIG. 9 - AUGER ADAPTER GUARD INSTALLED

- (g) Shift the rear ends of the lower links to a higher or lower position. Lowering them will lower the digger, raising them will raise the digger.
- (h) Check the tractor hydraulic system to be sure it is raising and lowering to the maximum and minimum heights recommended in your tractor manual.

NOTE The gearbox of the G20/40 Danuser digger is shipped dry!

STEP 6: Remove the fill plug at the top of the gearbox and fill the gearbox with two quarts of multigear lubricant EP SAE 140 *before operating the gearbox*. Tip the gearbox 45° (avoid pinchpoints as the gearbox pivots) and check the level at the plug (see Fig. 5). **DO NOT OVERFILL!** Replace the plug before operating the digger.

STEP 7: Grease the inside of the auger adapter liberally and attach the auger with the standard Danuser 1/2"-13 x 3 1/4" retaining bolt (PN 6014) and nut PN 1056. Never use a bolt longer than 3 1/4".

NOTE Each time an auger or auger extension is attached to the gearbox, the inside of the adapter should be coated liberally with grease.

STEP 8: Remove the three bolts around the pinion shaft of the gearbox and discard them (see Fig. 6). Install the auger adapter shield assembly bracket (PN 6139) and secure it around the pinion shaft with the three bolts provided (PN 6059).

STEP 9: Slide the input shaft guard (PN 6057) over the gearbox pinion (see Fig. 7). Slide the nonsplined end of the driveline over the gearbox pinion shaft and secure with 5/16-18 shear bolt PN 6015. Drive roll pin PN 6061 through the hole in the input shaft guard and into the end yoke so it rides in the groove in the pinion (the roll pin retains the driveline if the shear bolt breaks and falls out).

STEP 10: Pack 1/4 lb of good grade gun grease into the open end of the driveline and insert the driveline shaft into the drive tube. Grease the three lube fittings in the driveline and center crosses.

WARNING

To avoid personal injury, you must stop tractor engine, set brakes and remove the tractor key before proceeding with the next step!

STEP 11: Make sure the tractor engine is shut off, then connect the driveline to the tractor PTO. The drive shaft locks on with a retractable retaining ring coupling device—slide the ring back for installation (see Fig. 8).

STEP 12: Install the auger adapter shield PN 6137 around the auger adapter and secure to the shield assembly bracket PN 6139 with four Grade 5 bolts PN 2339 and four nuts PN 2168 (see Fig. 9).

NOTE To prevent damaging the driveline and safety shields when removing the digger from the tractor, disconnect the driveline from the tractor PTO before lowering the digger to the ground.

NOTE Refer to your tractor operator's manual for instructions on tractor operation, tire inflation, and safety when using a 3-point mounted implement.

Adjustment

CAUTION

Driveline shaft engagement should not be less than 10" when the digger is raised to its maximum height.

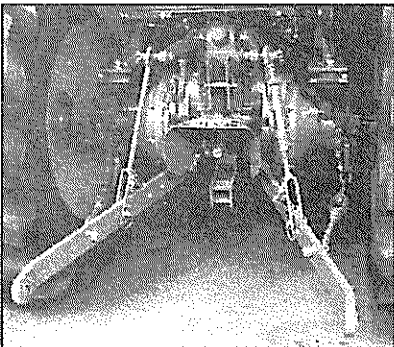

FIG. 3 - REPRESENTATIVE 3-POINT HITCH CONFIGURATION

CAUTION

Because of the weight of some components, and because some components are difficult to balance during assembly, two people are required for safe assembly of this equipment.

STEP 2: Attach the boom to the tractor upper link bracket with the tractor upper link pin. Avoid pinchpoints around the pin during assembly.

CAUTION

Sway stabilizers must be used with the digger.

STEP 3: Slip the lower link ball joints over the digger yoke link pins and secure with the klik pins provided with your tractor hitch. Keep hands away from pinchpoints while sliding components together.

STEP 4: Stand the digger gearbox (PN 6042) in an upright position, resting on the spindle. Lower the boom to the gearbox and attach the gearbox to the boom, using pin PN 6056 and retaining rings PN 2172. Avoid pinchpoints as the gearbox pivots.

STEP 5: Raise the boom to the highest point and make sure there is no contact between the boom and the tractor at any point. If necessary, adjust the travel of the boom to provide maximum travel without boom/tractor contact.

Boom travel adjustment procedures:

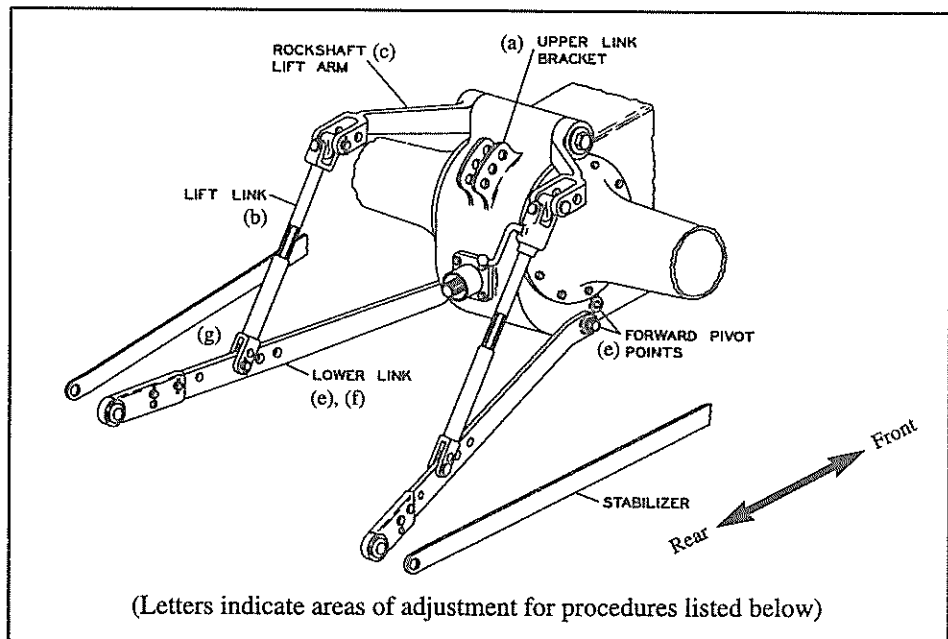

FIG. 4 - ADJUSTMENT POINTS

- (a) Attach the boom to the tractor through a different hole in the upper link bracket. Upper holes will shorten travel, lower holes will increase travel.
- (b) Shorten or lengthen the lift links.
- (c) Attach the lift links to different holes in the rockshaft lift arms. Rear holes increase boom travel, front holes decrease it.
- (d) Move the lift links to different holes in the lower links. Front holes usually increase travel, rear holes decrease travel.
- (e) Attach the lower links to different forward pivot points. Lower points will raise the digger, upper points will lower the digger.
- (f) Lengthen the lower links to raise the digger, shorten them to lower it.

Assembly/ Installation

- Description
- Tools required for installation
- Assembly/Installation



WARNING

Serious injury or death can result from misuse of this equipment.



WARNING

Personal protection equipment including hard hat, safety glasses, safety shoes, and gloves are recommended during installation, operation, adjustment, maintaining, repairing, removal, or moving the digger. Do not allow long hair, loose fitting clothing, or jewelry to be around moving parts.

Danuser G20/40 digger description

The Danuser G20/40 digger is built to the exacting standards of high quality which have become synonymous with the word "Danuser." The G20/40 digger is designed for one-man operation from the tractor seat to "Dig Holes Sitting Down." The heat-treated forged steel gear set, tapered roller bearings, and tubular crane boom form an integrated design to provide the ultimate in utility and reliability. Danuser augers are available in sizes ranging from 4 inches to 24 inches in diameter, 40 inches long. A 7" extension is also available. The augers are built with special wear-resistant steel on the lower flights, replaceable cutting edges, and replaceable points. The augers are attached to the gearbox by a Grade 8 bolt. The shear bolt is a Grade 5 bolt and connects the driveline to the gearbox pinion. Study this owner's manual carefully before attempting to assemble and operate the digger.

Tools required for assembly

- Hammer or mallet
- Roll pin punch
- Emery cloth
- 9/16" and 5/8" wrenches for safety guard bolts and nuts.

Assembly instructions



CAUTION

Because of the weight of some components, and because some components are difficult to balance during assembly, two people are required for safe assembly of this equipment.

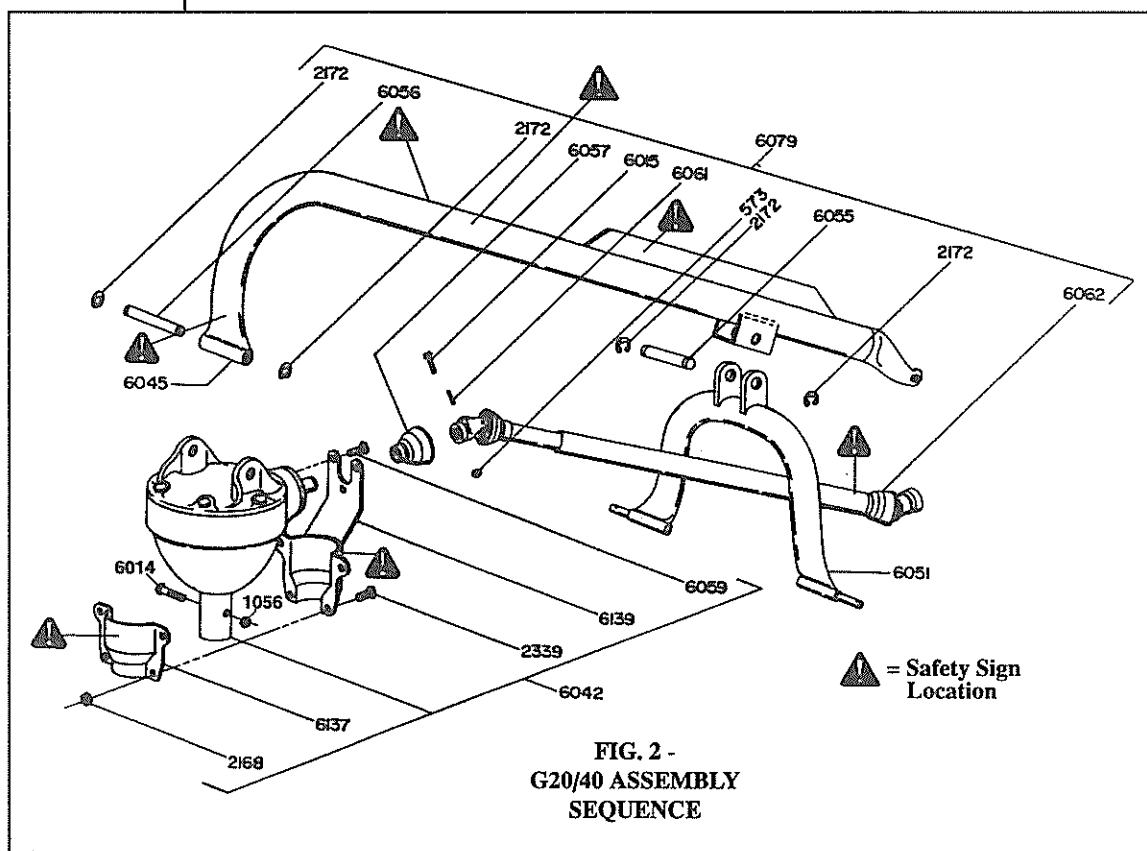

STEP 1: Attach the yoke to the crane boom, using pin PN 6055 and retaining rings PN 2172. Stabilize components to avoid pinchpoints during assembly.

Operating Safety

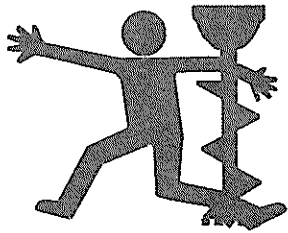

PREPARATION PROCEDURE

- Thoroughly read and understand your Operator's Manuals.
- Before beginning operation, clear area of objects that could wrap around the auger or might be thrown. Contact local utility companies to make certain there are no buried gas lines, electrical cables, etc., in the work area. Check for ditches, stumps, holes or other obstacles that could cause the tractor to roll.
- Layout and mark where you want to dig your holes.
- ALL persons should be at least twenty-five feet (25') away. Clear the area of helpers, bystanders, especially children.
- Do not allow anyone to stand behind, or to the side of, a rotating auger.
- To dig properly, your digger must be able to raise and lower through the highest and lowest points of your lift-arm travel without binding against the tractor frame. Check carefully BEFORE attaching the auger. If it does bind, adjust the tractor 3-point linkage so that all movement is free.

If you have **any** questions regarding the proper assembly or operation of this digger, contact your dealer or the manufacturer.

OPERATION

This post hole digger was designed for one-man operation from the tractor seat. It is the responsibility of the operator to see that no one is within twenty-five feet (25') of the digger when it is started.

- Set tractor brakes.
- Take tractor out of gear.
- Lower auger point slowly to the ground with the PTO disengaged.
- With the auger point lowered to the ground, set the engine speed to idle, then engage the PTO. Make sure the auger point is on the ground before engaging the PTO.
- Under no circumstances should the PTO be run in excess of 540 RPM.
- In many types of soil, it may be necessary to hold back against the auger screw suction by moving the hydraulic control lever to "HOLD" or "RAISE" position to keep the auger from screwing into the ground.
- NEVER use body weight to help the auger penetrate the ground. When the ground is too tough to penetrate with your cutting edges and point, replace them and try again. These are replaceable parts and must be in good condition to penetrate.
- If you have difficulty penetrating hard ground, refer to Owner's Manual for suggestions.
- When the auger has been lowered a foot or so into the ground, raise the auger almost out of the hole to clear the dirt, then drill deeper and raise the auger again. Repeat this procedure until the desired hole depth is reached.
- When the auger has reached the full depth required, allow the auger to dwell momentarily at this depth at a slower speed to assist in cleaning out the hole.
- Disengage the PTO and raise the auger from the hole.
- Do not shovel dirt away from a rotating auger, as the shovel can be caught and thrown by the auger.
- Leave the power take off disengaged when traveling between holes.

IT IS ESSENTIAL THAT EVERYONE INVOLVED IN THE ASSEMBLY, OPERATION, TRANSPORT, MAINTENANCE, AND STORAGE OF THIS EQUIPMENT BE AWARE, CONCERNED, PRUDENT, AND PROPERLY TRAINED IN SAFETY.

Safety

(continued)

- To prevent entanglement and possible serious injury or death, never use body weight to try to push auger into the ground.
- Worn edges or a slightly rounded point can seriously affect auger penetration. Check for wear before each use, replace as necessary.
- Do not shovel dirt away from a rotating auger, as the shovel can be caught and thrown by the auger.
- Do not operate the Post Hole Digger without all safety shields and guards in place.
- Always use care when operating a Post Hole Digger.

Safety is a primary concern in the design, manufacture, sale, and use of Post Hole Diggers. As manufacturers of Post Hole Diggers, we want to confirm to you, our customers, our concern for safety.

Our current production machines include, as standard equipment, guards or shields for auger adapters, drivelines, input shafts, and safety signs. Older machines can be retrofitted to add these new guards or shields and, of course, safety signs. If you have an older machine which does not have current standard safety equipment, please contact your dealer about bringing your machine up to the current level of safety.

**PLEASE READ ALL OF THE PREPARATION PROCEDURE AND
OPERATION SAFETY WARNINGS ON PAGE 8 OF THIS MANUAL PRIOR
TO OPERATING YOUR DANUSER POST HOLE DIGGER!**

Safety

(continued)

- Personal protection equipment including hard hat, safety glasses, safety shoes, and gloves are recommended during assembly, installation, operation, adjustment, maintaining, repairing, removal, or moving the digger. Do not allow long hair, loose fitting clothing or jewelry to be around moving parts.
- Always use two people to handle heavy, unwieldy components during assembly, installation, removal, or moving the digger.
- Never place any part of your body where it would be in danger if movement should occur during assembly, installation, operation, maintaining, repairing, removal, or moving the digger.
- Never place yourself between the tractor and digger while implement is in operation.
- Do not walk or work under a raised digger or attachment unless it is securely blocked or held in position. Do not depend on the tractor hydraulic system to hold the digger or attachment in place.
- A heavy load can cause instability of the tractor. Use extreme care during travel. Slow down on turns and watch out for bumps. The tractor may need front counterweights to counterbalance the weight of the digger.
- Never use alcoholic beverages or drugs which can hinder alertness or coordination while operating this equipment. Consult you doctor about operating this machine while taking prescription medications.
- Do not allow riders on the digger or tractor at any time. There is no safe place for any riders.
- Before you operate the digger, check over all pins, bolts and connections to be sure all are securely in place. Replace any damaged or worn parts immediately.
- Consult local utility companies to make certain there are no buried gas lines, electrical cables, etc., in the work area before beginning operation.
- Do not allow anyone who is not familiar with the safety rules and operation instructions to use this Post Hole Digger.
- Never allow children to operate or be around this digger.
- Use stabilizer bars, adjustable sway chains, or sway blocks on your tractor lift arms to keep the Post Hole Digger from swinging side to side. Adjust as tightly as practical for best performance.
- Never replace the shear bolt OR auger retaining bolt with any length other than what is specified in this manual. A longer, or protruding, fastener is more likely to grab loose clothing or gloves, which can result in serious injury or death.
- Clear the work area of objects which might be picked up and thrown or entangled in the auger.
- To prevent rapid wear of U-Joints and possible failure of drivelines, never lift auger point more than 12" off the ground with PTO operating.
- To prevent possible instantaneous driveline failure, never move digger from hole-to-hole or transport while auger is rotating. This could lead to injury from flying pieces of the failed driveline.
- Do not operate digger on steep hillsides. When digging on uneven or hilly terrain, position the tractor with the Post Hole Digger uphill. With the Post Hole Digger downhill, the tractor could tip when attempting to pull the auger from its hole.
- Never position the auger point by hand or with any tool when the tractor is running.
- Never position the auger point by putting your hands on the auger, gearbox, boom, or driveline.
- Keep hands, feet, hair, jewelry, and clothing away from all moving and/or rotating parts.

Safety



This SAFETY ALERT

symbol identifies important safety warning messages.

Carefully read each warning message that follows. Failure to understand and obey a safety warning, or recognize a safety hazard, could result in injury or death to you or others around you. The operator is ultimately responsible for the safety of himself, as well as others, in the operating area of the Post Hole Digger.



WARNING

IMPORTANT

Working with unfamiliar equipment can lead to careless injuries. Read this manual, and the manual for your tractor, before assembly or operating, to acquaint yourself with the machines. It Is The Post Hole Digger Owner's Responsibility, If This Machine Is Used By Any Person Other Than Yourself, Is Loaned Or Rented, To Make Certain That The Operator, Prior To Operating:

1. Reads And Understands The Operator's Manuals
2. Is Instructed In Safe And Proper Use

The majority of accidents involve entanglement on the driveline or auger. This entanglement risk becomes greater when you replace our shear bolts OR auger retaining bolts with bolts longer than those specified by the manufacturer. This improper replacement occurs most often on machines that are loaned or rented to someone who has not read the owner's manual and is not familiar with a Post Hole Digger.

- This Post Hole Digger was designed for one-man operation from the tractor seat. It is the responsibility of the operator to see that no one is within twenty-five feet (25') of the digger when it is started. Do not operate the digger with another person near, or in contact with, any part of the digger, PTO driveline, or auger. Serious personal injury or death may result if any attempt is made to assist digger operation by hand.
- The use of this equipment is subject to certain hazards which cannot be protected against by mechanical means or product design. All operators of this equipment must read and understand this entire manual, paying particular attention to safety and operating instructions, prior to using. If there is something in this manual you do not understand, ask your supervisor or your dealer to explain it to you.
- Most accidents occur because of neglect or carelessness. Keep all helpers and bystanders twenty-five feet (25') away from an operating digger. Only properly trained people should operate this machine. It is recommended the tractor be equipped with a Rollover Protection System (ROPS) and a seat belt that is used. Always stop the PTO, set brake, shut off the tractor engine, remove the tractor key, and allow auger to come to a complete stop before dismounting tractor. Never leave equipment unattended with the tractor running.
- Please remember it is important that you read and heed the safety signs on the digger, and the safety rules set forth. Clean or replace all safety signs if they cannot be clearly read and understood. They are there for your safety as well as the safety of others. The safe use of this machine is strictly up to you, the operator.
- All things with moving parts are potentially hazardous. There is no substitute for a cautious, safe-minded operator who recognizes potential hazards and follows reasonable safety practices. The manufacturer has designed this digger to be used with all its safety equipment properly attached, to minimize the chance of accidents. Study this manual to make sure you have all safety equipment attached.
- If a safety shield or guard is removed for any reason, it must be replaced before the machine is again operated. Always use, and maintain in place, all power take off guards furnished with the tractor as well as the power take off guards and shields furnished with the digger.
- This digger is designed for use only on tractors with 540 RPM power take off.
- When the use of hand tools is required to perform any part of assembly, installation, adjustment, maintaining, repairing, removal, or moving the digger, be sure the tools used are designed and recommended by the tool manufacturer for that specific task.

Foreword

- Introduction
- Symbols

SYMBOLS

Table of Contents

Please read this manual thoroughly!

Before you assemble your Danuser digger, read this manual thoroughly. If there is anything you do not understand, contact your dealer, or call the factory direct at 573-642-2246 before proceeding with assembly. Powered equipment can be dangerous if it is not assembled and used properly.

Warranty registration

Your warranty registration form serves two purposes: it provides dating information for warranty coverage; and it allows Danuser to notify you, the owner, of improvements to the equipment or of new safety features that may be retrofitted to previously sold diggers. Your satisfaction with our product and your safety as a user of our product are both very important to us. Please return your registration form so we can provide this service for you.



Meaning:

This is important information for proper use of this system or equipment. Failure to comply may lead to premature equipment failure.



CAUTION

Meaning:

Failure to follow these instructions may cause damage to the implement or the tractor, or minor personal injury.



WARNING

Meaning:

Failure to follow these instructions may result in personal injury or death.

⚠ DANGER

Meaning:

Immediate hazard! Failure to understand and obey this warning is likely to result in personal injury or death.

	Page
Foreword.....	3
Symbols Used in this Manual	3
Preparation	4
Package Inspection	4
Component Identification	4
Safety	5
General Safety	5
Operating Safety	8
Assembly/Installation	9
Description.....	9
Tools Required for Installation	9
Assembly	9
Adjustment Procedures.....	10
Troubleshooting	12
Operation.....	13
Maintenance.....	14
Parts.....	15
Decal and Safety Sign Identification/Location.....	15
G20/40 Digger Parts	16
G20/40 Gearbox Assembly.....	17
G20/40 Driveline Parts	18
G20/40 Auger Assemblies.....	19
G20/40 Accessories	20
Warranty.....	23

Preparation

- Package Inspection
- Component Identification

Check for shipping damage immediately, and verify that all components have been received.

Report all shipping damage to the carrier immediately.

Before you begin assembly, open all packaging and compare the contents to the photo below to ensure that you have all of the components, and that your unit has all of the safety guards and safety signs required by current production safety standards. If your unit does not comply, contact Danuser Machine Co., Inc., IMMEDIATELY at 573-642-2246.

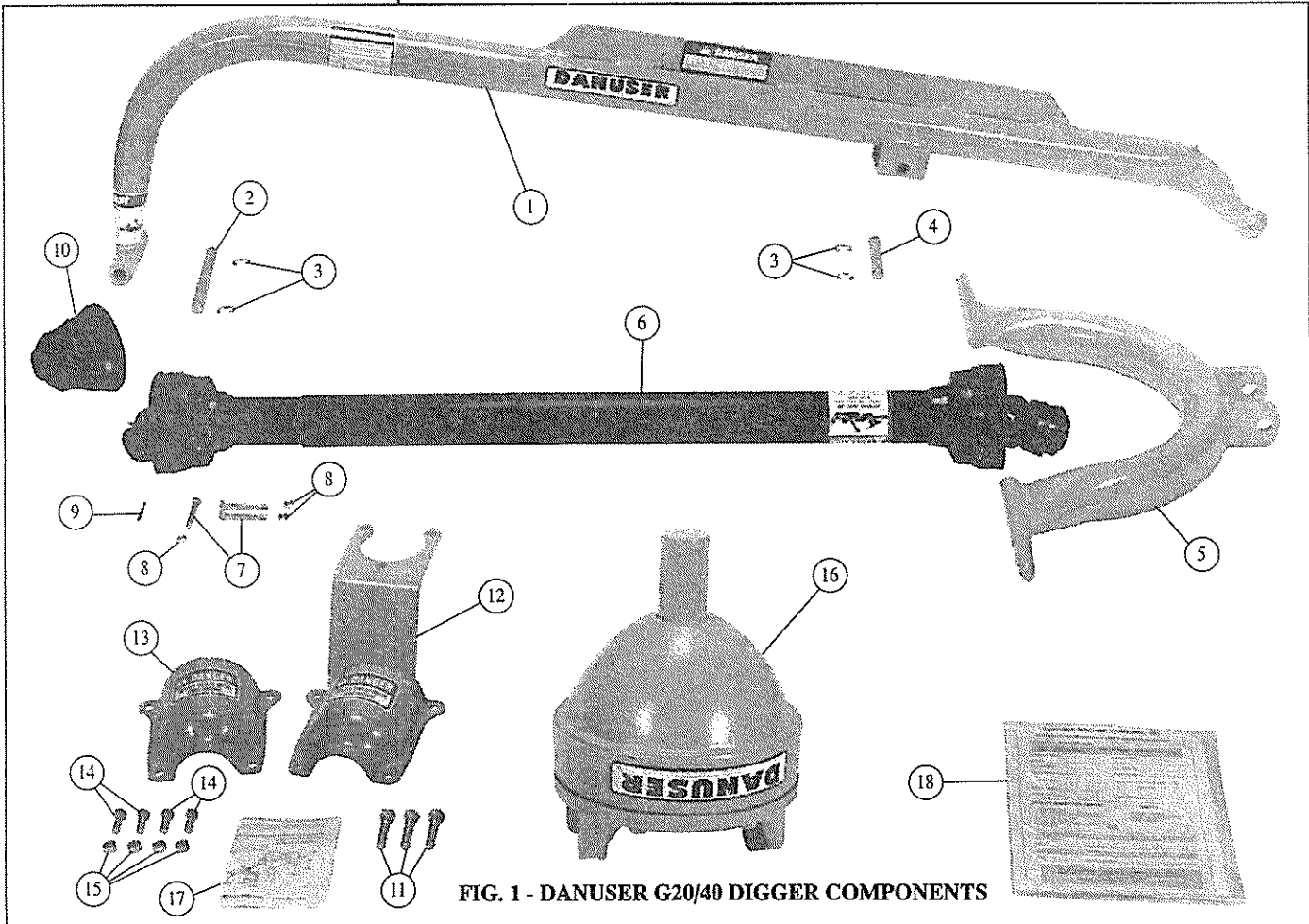

FIG. 1 - DANUSER G20/40 DIGGER COMPONENTS

Description	Part No.	Quantity
1. G20/40 boom	PN 6045	1
2. Pin (3/4 x 8)	PN 6056	1
3. Retaining ring	PN 2172	4
4. Pin (3/4 x 4-15/16)	PN 6055	1
5. Yoke assembly	PN 6051	1
6. Driveline	PN 6062	1
7. Bolt, shear (5/16-18 x 2-1/4, Gr. 5)	PN 6015	3
(one required in unit, two spares included in package)		
8. Nut (5/16-18)	PN 573	3
9. Roll pin (3/16 x 1-1/2)	PN 6061	1
10. Guard, input shaft	PN 6057	1
11. Bolt (7/16-14 x 1-3/4, Gr. 5)	PN 6059	3
12. Shield assembly bracket	PN 6139	1
13. Shield, auger adapter	PN 6137	1
14. Bolt (3/8-16 x 7/8, Gr. 5)	PN 2339	4
15. Nut (3/8-16)	PN 2168	4
16. G20/40 gearbox	PN 6042	1
17. Instructions, auger adapter shield installation		1
18. Owner's Manual		1