

(Parts Pages Follow)

ATTENTION

If you need an Owner's/Operator's Manual and/or safety signs (decals), then please contact Danuser. Provide your Model Number and Serial Number, and we will be happy to mail it to you.

Danuser Machine Company, Inc.
500 E. 3rd St.
P.O. Box 368
Fulton, MO 65251
Tel: (573) 642-2246
Fax: (573) 642-2240
E-mail: sales@danuser.com

Digger Assembly

Ref. No.	Description	Part No.	No. Req'd
	Hydraulic Digger, complete		1
	Model 8900-4	9554	
	Model 8900-7	9557	
	Model 8900-8	9558	
1	Socket Head Bolt (1/2"-13 x 1-1/2")	6156	2
2	Hydraulic Motor		1
	Model 8900-4	9549	
	Model 8900-7	9556	
	Model 8900-8	9556	
3	Planetary Gearbox		1
	Model 8900-4	9870	
	Model 8900-7	9870	
	Model 8900-8	9869	
4	Special Retaining Bolt (1/2"-13 x 4", Gr. 8)	9569	1
5	Retaining Nut (1/2"-13)	1056	1
6	Housing Assembly	9560	1
7	Bolt (1/2"-13 x 1-1/4", Gr. 8)	6231	8
8	Auger Adapter Shield		2
	Model 8900-4	7271	
	Model 8900-7	7271	
	Model 8900-8	9542	
9	Bolt (3/8"-16 x 1-1/4", Gr. 5)	1180	2
10	Bolt (3/8"-16 x 7/8", Gr. 5)	2339	2
11	Nut (3/8"-16)	2168	4
12	Serial Number Tag		1
13	Output Spindle Seal (see image below)	9871	1

 = Safety Sign Location

Safety Sign	6213	1
Safety Sign	PHDC4	1
Safety Sign	DIG5	1
Safety Sign	2169	2

WARNING

On models with round output spindles (8900-4 and 8900-7), provided Auger Adapter Guard PN 7270 will accommodate augers with 2-3/8" center column. Auger Adapter Guard PN 9545 is required when using augers with 3-5/8" center column (Danuser Hole Digger Head 24" and larger diameter augers).

Hex spindle model (8900-8) is shipped with the larger Auger Adapter Guard PN 9545.

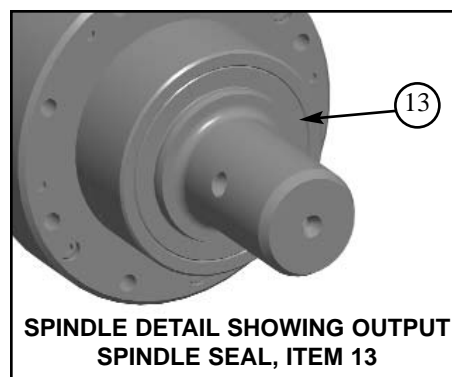
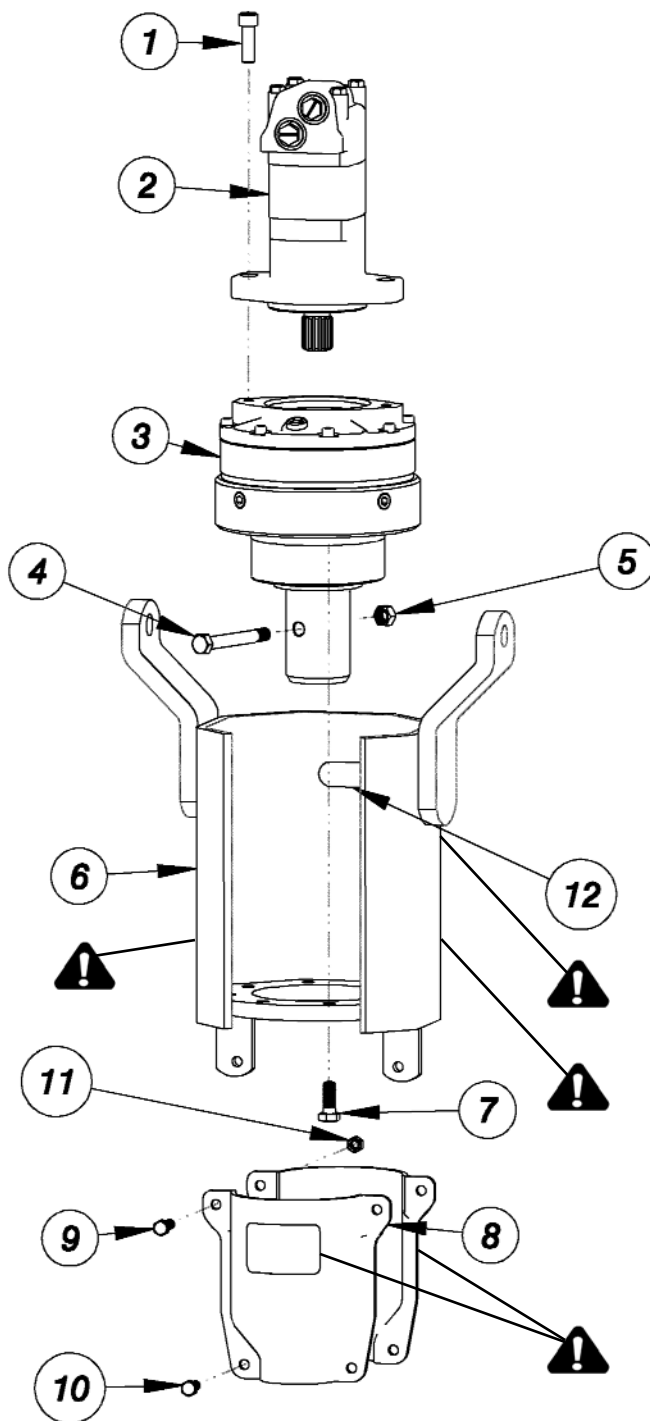

SPINDLE DETAIL SHOWING OUTPUT SPINDLE SEAL, ITEM 13

Auger Assemblies

NOTE

Danuser Augers come with hardware (items similar to 9, 10, and 11) that is not designed for use with the 8900 Hydraulic Digger and should be discarded. Use bolt PN 9569 and nut PN 1056 that came attached to the 8900 Digger spindle.

8900-4 & 8900-7

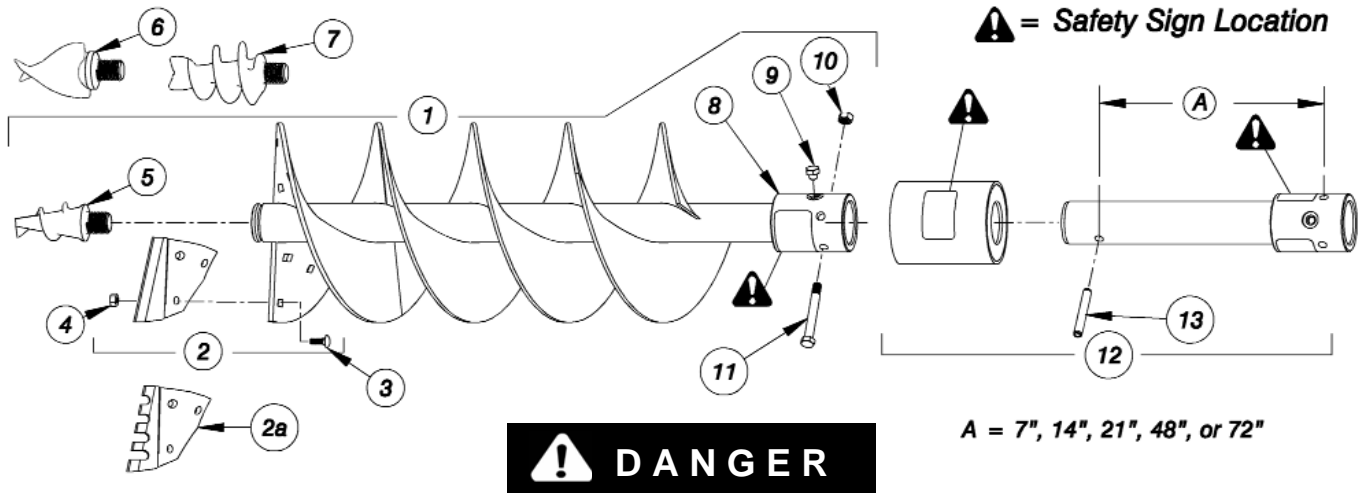

When using an extension, Ref. No. 10 (PN 1056) and Ref. No. 11, (PN 9569) should be relocated from the auger adapter to the extension adapter, and Ref. No. 13 (PN 9548) should be used to attach the auger to the extension to avoid possible entanglement.

NOTE

Danuser Augers have replaceable points and edges. Serrated cutting edges (Ref. No. 2a) and optional points (Ref. No. 6 and Ref. No. 7) are available to aid penetration in tough digging conditions. Flights are replaceable except on 4" and 6" augers, where the flight is a continuous spiral. Cutting edges for 4" and 6" augers are welded on the auger.

8900 AUGER ASSEMBLIES FOR 2-9/16" ROUND SPINDLES

Ref. No.	Part Number by Auger Diameter											Description	No. Req'd
	4"	6"	9"	10"	12"	14"	16"	18"	24"	30"	36"		
1	See next page for available augers.											Auger	1
2	7782	7783										Plain Cutting Edges (Weld On) - NOT SHOWN	1 Set
			7784	7788	7790	7792	7794	7796	7798	7890	7784 * 7890 *	Plain Cutting Edges (with Bolts & N uts)	1 Set
2a			7785	7789	7791	7793	7795	7797	7799	7883	7785 * 7883 *	Serrated Cutting Edges (with Bolts & Nuts)	1 Set
3			784	784	784	784	784	784	784	784	784	Cutting Edge Bolt (3/8"-16 x 1" Carriage)	As Req'd
4			785	785	785	785	785	785	785	785	785	Cutting Edge Nut (3/8"-16 Hex)	As Req'd
5	899	831	831	831	831	831	831	831	831	831	831	Standard Auger Point	1
6		1937	1937	1937	1937	1937	1937	1937	1937	1937	1937	Special Duty Auger Point	1
7		6210	6210	6210	6210	6210	6210	6210	6210	6210		Aggressive Duty Auger Point	1
8	7781	7781	7781	7781	7781	7781	7781	7781	7781	7781	7781	Auger Adapter Replacement (for Field Welding)	1
9	Discard bolt that came with auger.											Bolt Not Applicable to 8900 Hydraulic Digger	0
10	1056	1056	1056	1056	1056	1056	1056	1056	1056	1056	1056	Retaining Nut (1/2"-13 Hex)	1
11	Discard bolt that came with auger. Use PN 9569 that came with digger.											Retaining Bolt (1/2"-13 x 4", Gr. 8) SPECIAL BOLT: Use Genuine Danuser Replacement Only	1
12	See Accessories Page for available 2-9/16" Round Spindle Auger Extensions											Auger Extension with Guard	1
13	9548	9548	9548	9548	9548	9548	9548	9548	9548	9548	9548	Coiled Pin (1/2" x 3-1/2") SPECIAL PIN: Use Genuine Danuser Replacement Only	1

* = Additional flighting has been added to the perimeter of a 30" auger. Two sets of cutting edges are required: a 30" set and a 9" set.

2-9/16" Round Augers

 = Safety Sign Location

8900-4 & 8900-7

2-9/16" ROUND SPINDLE AUGERS (8900-4 & 8900-7)

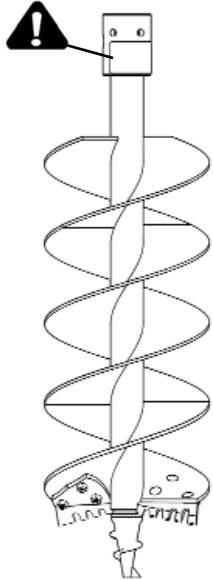

Part Number by Auger Diameter											Description
4"	6"	9"	10"	12"	14"	16"	18"	24"	30"	36"	
450	417	1551	288	412	451	7650	1275	1270	7857	9618 *	40" Long with Plain Edges & Std. Point
		1552	487	488	489	7665	1276	1272	7935	9614 *	40" Long with Serrated Edges & Std Point
	9387	9314	9315	9316	9317	9318	9319	9320 #	9321 #	9412 #	40" Long with Hole Digger Head & HDH Point
		7476	7478	7419	7437	7661					52" Long with Plain Edges & Std. Point
		7497	7498	7499	7519	7734					52" Long with Serrated Edges & Std. Point
		9322	9323	9324	9325	9326					52" Long with Hole Digger Head & HDH Point
						9359 ●	9361 ●	9363 ● #	9365 ● #		52" Long with Hole Digger Head & HDH Point
		7846	7848	7850	7852	7854	7604				72" Long with Plain Edges & Std. Point
		7936	7937	7938	7939	7940	7605				72" Long with Serrated Edges & Std. Point
		9327	9328	9329	9330						72" Long with Hole Digger Head & HDH Point
						9331 ●	9332 ●				72" Long with Hole Digger Head & HDH Point

* = These 36" augers have 30" & 9" cutting edges. Refer to PN 9412 for heavy industrial use.

= These augers have 3-5/8" columns. Auger Adapter Guard PN 9545 must be purchased and used to cover the 3-5/8" center column augers.

● = These augers have single flight construction.

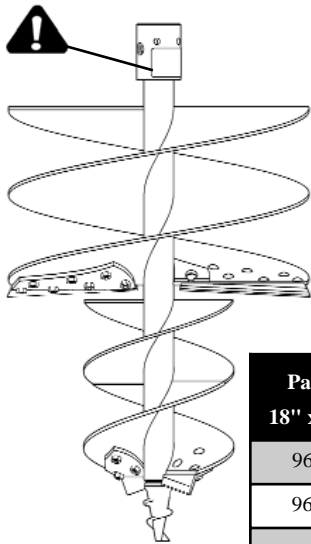

2-9/16" ROUND SPINDLE TREE AUGERS (8900-4 & 8900-7)

Part Number by Auger Diameter			Description
18" x 10"	24" x 12"	30" x 16"	
9611			33" Long with Plain Edges & Std. Point - Auger Uses Both Dimensions of Cutting Edges
9615			33" Long with Serrated Edges & Std Point - Auger Uses Both Dimensions of Cutting Edges
	9612	9613	40" Long with Plain Edges & Std. Point - Auger Uses Both Dimensions of Cutting Edges
	9616	9617	40" Long with Serrated Edges & Std. Point - Auger Uses Both Dimensions of Cutting Edges

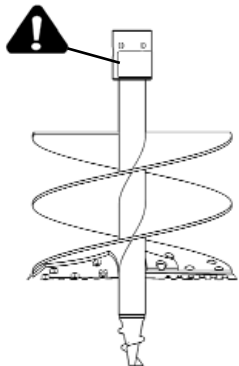

2-9/16" ROUND SPINDLE ORCHARD AUGERS (8900-4 & 8900-7)

Part Number by Auger Diameter		Description
18"	24"	
9850	9849	29" Long with Serrated Edges & Std. Point

Hole Digger Head Auger Assemblies

8900-4 & 8900-7

NOTE

Danuser Augers come with hardware (items similar to 2, 3, and 4) that is not designed for use with the 8900 Hydraulic Digger and should be discarded. Use bolt PN 9569 and nut PN 1056 that came attached to the 8900 Digger spindle.

NOTE

Hole Digger Head Augers have replaceable points and teeth. Flights are replaceable, except on 6".

NOTE

Auger point PN 9353 is the only auger point that can be used with Hole Digger Heads.

 = Safety Sign Location

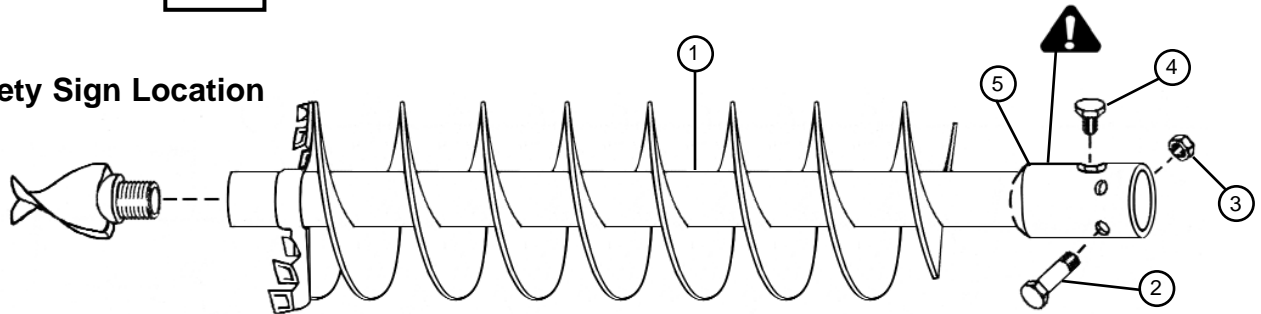

8900 HOLE DIGGER HEAD AUGER ASSEMBLIES FOR 2-9/16" ROUND SPINDLES

Ref. No.	Part Number by Auger Diameter										Description	No. Req'd
	6"	9"	10"	12"	14"	16"	18"	24"	30"	36"		
1	9387	9314	9315	9316	9317	9318	9319	9320 #	9321 #	9412 #	40" Hole Depth Auger with Double Flight Construction	1
		9322	9323	9324	9325	9326					52" Hole Depth Auger with Double Flight Construction	1
						9359	9361	9363 #	9365 #		52" Hole Depth Auger with Single Flight Construction	1
		9327	9328	9329	9330						72" Hole Depth Auger with Double Flight Construction	1
						9331	9332				72" Hole Depth Auger with Single Flight Construction	1
2	Discard bolt that came with auger. Use PN 9569 that came with digger.										Retaining Bolt (1/2"-13 x 4", Gr. 8) SPECIAL BOLT: Use Genuine Danuser Replacement Only	1
3	1056	1056	1056	1056	1056	1056	1056	1056	1056	1056	Retaining Nut (1/2"-13 Hex)	1
4	Discard bolt that came with auger.										Bolt Not Applicable to 8900 Hydraulic Digger	0
5	7781	7781	7781	7781	7781	7781	7781	7781	7781	7781	Auger Adapter Replacement (for Field Welding)	1

= These augers have 3-5/8" columns. Auger Adapter Guard PN 9545 must be purchased and used to cover the 3-5/8" center column augers.



Hole Digger Head Kits can be welded onto plain and serrated augers.

HOLE DIGGER HEAD KIT* (Field Weld to Auger)

Auger Diameter	No. Teeth per Head	Part. No.
6"	2	.9386
9"	4	.9306
10"	4	.9307
12"	4	.9308
14"	6	.9309
16"	6	.9310
18"	6	.9311
24"	8	.9312
30"	10	.9313
36"	12	.9416

* Includes head with teeth and roll pins, point and point adapter with tube, for welding to auger center column.

HOLE DIGGER HEAD REPLACEMENT PARTS

Ref. No.	Description	Part. No.
1	Hole Digger Head Point	9353
2	Hole Digger Head Tooth	9234
	Hard-Surface Tooth (option)	9964
3	Roll Pin (5/16" x 1-1/4")	7483

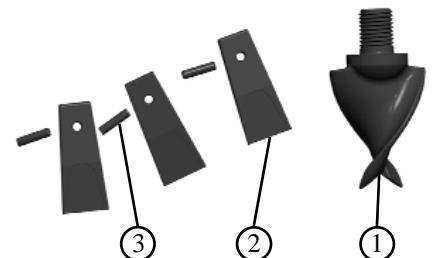

Auger Assemblies

8900-8

NOTE

Danuser Augers come with hardware (items similar to 2 and 3) that is not designed for use with the 8900 Hydraulic Digger and should be discarded. Use bolt PN 9569 and nut PN 1056 that came attached to the 8900 Digger spindle.

NOTE

Hole Digger Head Augers have replaceable points and teeth. Flights are replaceable, except on 6".

NOTE

Auger point PN 9353 is the only auger point that can be used with Hole Digger Heads.

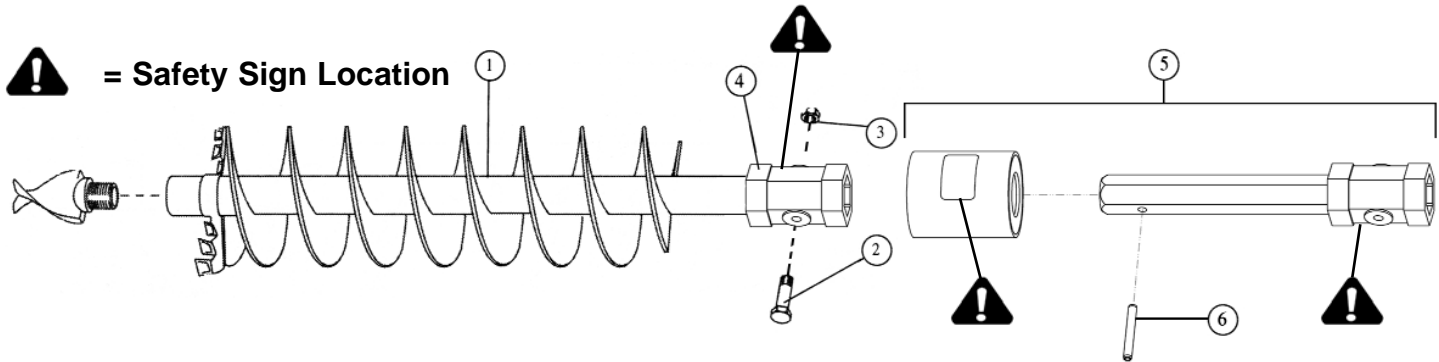

! DANGER

When using an extension, Ref. No. 2 (PN 9569) and Ref. No. 3 (PN 1056) should be relocated from the auger adapter to the extension adapter, and Ref. No. 6 (PN 9548) should be used to attach the auger to the extension to avoid possible entanglement.

8900 HOLE DIGGER HEAD AUGER ASSEMBLIES FOR 2" HEX SPINDLES

Ref. No.	Part Number by Auger Diameter										Description	No. Req'd
	6"	9"	10"	12"	14"	16"	18"	24"	30"	36"		
1	9902	9903	9904	9905	9906						40" Hole Depth Auger with Double Flight Construction	1
						9571	9572	9573 #	9574 #	9575 #	40" Hole Depth Auger with Single Flight Construction	1
		9706	9707	9708	9709						72" Hole Depth Auger with Double Flight Construction	1
						9710	9711				72" Hole Depth Auger with Single Flight Construction	1
2	Discard bolt that came with auger. Use PN 9569 that came with digger.										Retaining Bolt (1/2"–13 x 4", Gr. 8) SPECIAL BOLT: Use Genuine Danuser Replacement Only	1
3	1056	1056	1056	1056	1056	1056	1056	1056	1056	1056	Retaining Nut (1/2"–13 Hex)	1
4	9581	9581	9581	9581	9581	9581	9581	9581	9581	9581	Auger Adapter Replacement (for Field Welding)	1
5	9622G	9622G	9622G	9622G	9622G	9622G	9622G	9622G	9622G	9622G	Auger Extension with Guard (7")	1
	9623G	9623G	9623G	9623G	9623G	9623G	9623G	9623G	9623G	9623G	Auger Extension with Guard (14")	1
	9624G	9624G	9624G	9624G	9624G	9624G	9624G				Auger Extension with Guard (21")	1
								9624G	9624G	9624G	Variable Auger Extension with Guard (14" and 21")	1
	9629G	9629G	9629G	9629G	9629G	9629G	9629G				Auger Extension with Guard (56")	1
								9629G	9629G	9629G	Variable Auger Extension with Guard (28", 35", 42" 49", and 56")	1
	9484G	9484G	9484G	9484G	9484G	9484G	9484G	9484G	9484G	9484G	Auger Extension with Guard (72")	1
6	9548	9548	9548	9548	9548	9548	9548	9548	9548	9548	Coiled Pin (1/2" x 3-1/2") SPECIAL PIN: Use Genuine Danuser Replacement Only	1

= These augers have 3-5/8" columns. Auger Adapter Guard PN 9545 must be purchased and used to cover the 3-5/8" center column augers.

Accessories

Standard



Special Duty



Aggressive Duty



Hole Digger Head Point not shown

Plain

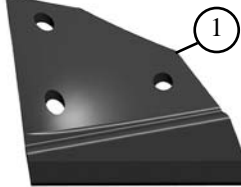

Serrated

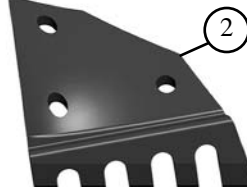

! = Safety Sign Location

72" not shown

Auger Extensions for 2" hex spindle diggers are not shown.

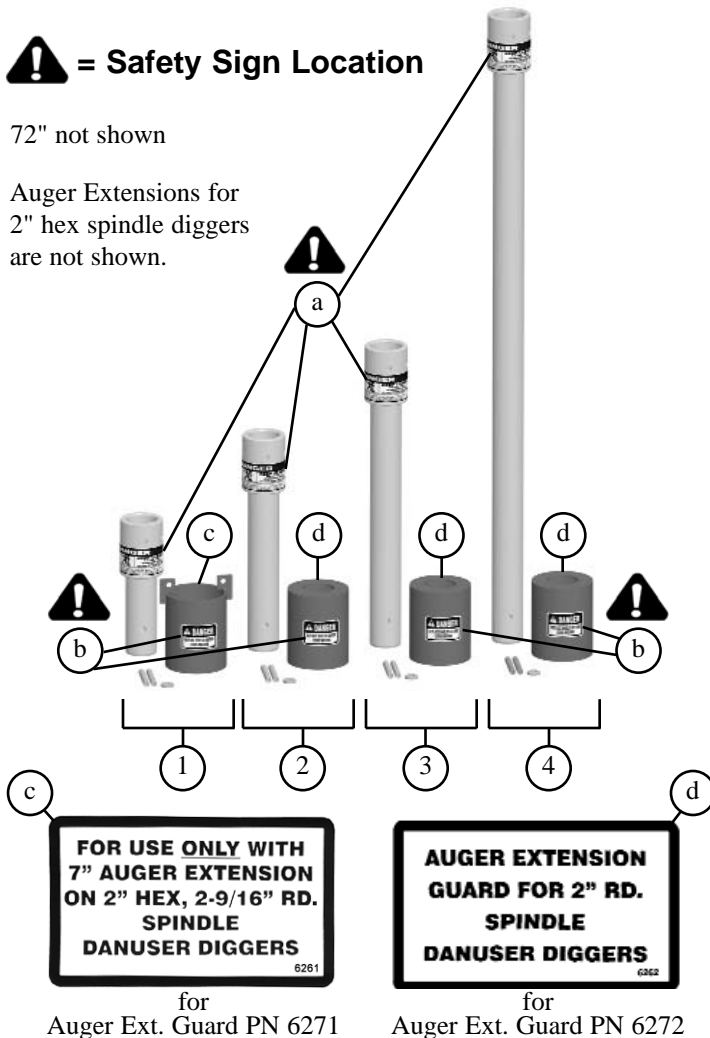

AUGER POINTS

Ref. No.	Description	Part No.
1	Standard for augers 6" through 36" diameter831
	only point for 4" augers899
2	Special Duty1937
3	Aggressive Duty6210
--	Hole Digger Head Point (not shown)9353

See Hole Digger Head Point on separate page.

CUTTING EDGES

Ref. No.	Description	Part No.
1	Plain	See charts
2	Serrated	See charts

See Hole Digger Head Teeth on separate page.

AUGER EXTENSIONS

Ref. No.	Description	Part No.	Description	Part No.
Each auger extension comes with two special coiled pins, a washer, and an Auger Extension Guard.				
<u>2-9/16" Round Spindles</u>			<u>2" Hex Spindles</u>	
1	7"1849G	7"9622G
2	14"7494G	14"9623G
3	21"7663G	* 21"9624G
4	48"9486G	* 56"9629G
--	72"9489G	72"9484G
a	Safety Sign . .PHDC5		* On 24", 30", & 36" hex	
b	Safety Sign2169		augers, these extensions	
c	Decal6261	will fit into the auger to	
d	Decal6263	make the length adjustable.	

For extra hole depth, 2-9/16" round auger extensions with Auger Extension Guards are available in lengths of 7, 14, 21, 48, and 72 inches, and 2" hex auger extensions with Auger Extension Guards are available in lengths of 7, 14, 21, 56, and 72 inches. Make sure that your vehicle can accommodate the extra length and still have adequate clearance. Use **only** factory supplied coiled pins to connect the auger to the auger extension. Two coiled pins are shipped with the auger extension, one to install and one spare. When installed, the coiled pin must be flush with the sides of the auger, and the area should be covered by the Auger Extension Guard. The auger retaining bolt should be covered by the Auger Adapter Guard. For all unguarded Danuser auger extensions, guards are available. The washer (PN 40227) should be placed under the head of the retaining bolt on all 3-1/4" outside diameter adapters and hex adapters. 3-1/4" outside diameter adapters may include your auger or older (painted black) Danuser auger extension.

Accessories



DOWN FORCE KIT

A Down Force Kit (PN 9079) is available to make difficult digging easier.

The kit attaches to the boom without alteration and with the use of ordinary hand tools. It provides approximately 500 pounds of additional force to the auger point for easier penetration of hard or frozen ground.

The kit does not interfere with normal digging operations.

The kit operates from the tractor hydraulic system with normal remote cylinder outlets. Customer provides mating coupler tip to fit his particular tractor as well as sufficient hydraulic hose and fittings to connect the valve to the tractor sump.



8900 shown above

The Danuser Auger Cart, U.S. Patent No.: 6,419,245 B1, allows you to quickly and easily attach/detach, transport, and store Danuser 3-pt. Hitch Diggers: F8 (shown), G20/40, 8800, and 8900.

The Danuser Auger Cart has four wheels, steering capabilities, and a parking brake. It can be used on any level surface. Maximum auger diameter is 24".

